

Collins Building, 2 Wilkinson Close, Brand New Apartment

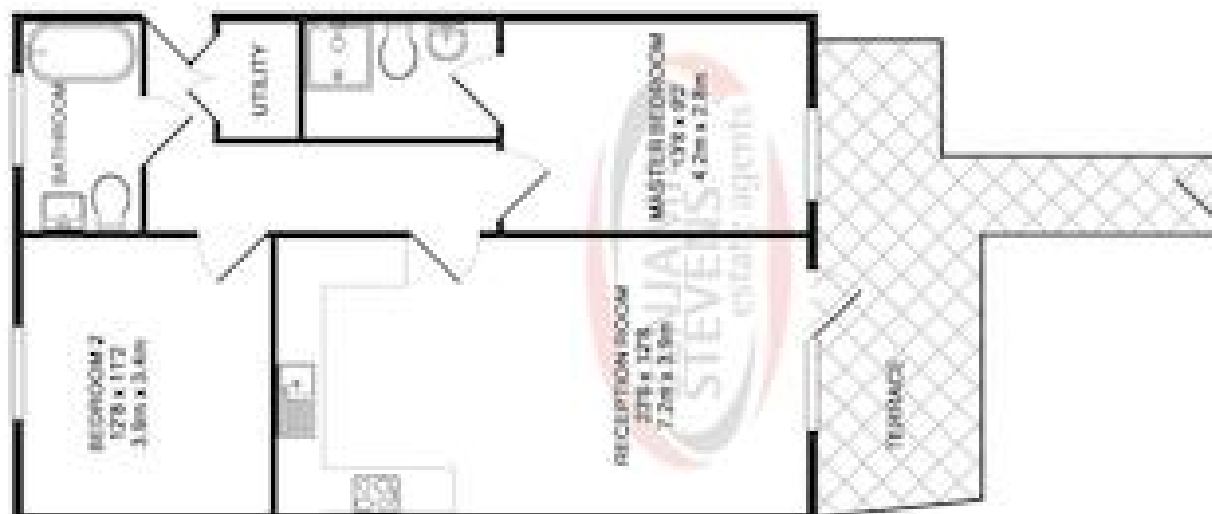

TOTAL APPROX. FLOOR AREA: 179.93 SQ. FT. (16.56 SQ. M)

Information is provided for general information only. It is not intended to constitute an offer of any financial product, and should not be relied upon as a basis for any investment decision. The information is provided for general information only and should not be used as a basis for any investment decision. The information is provided for general information only and should not be used as a basis for any investment decision. The information is provided for general information only and should not be used as a basis for any investment decision.

£ 499000/-

Half Moon Estate are pleased to present the brand new ground floor two bedroom two bathroom apartment with private terrace in the new development at Cricklewood NW2. Accommodation comprises two double bedrooms, two bathrooms (one en-suite) bespoke kitchen area with large reception room, private terrace and underground secure parking. Other facilities include use of the onsite gym, concierge service, bicycle storage and landscaped communal gardens. The property is brand new and chain free. Early viewing highly recommended.



2 Bedroom Flat
Next to Brent Cross Shopping mall
Collins Building, 2 Wilkinson Close
NW2, London.
2 Bathroom
Private GYM for the residents
Private car parking
Newly Built Apartment
Lift, 24 hours concierge service

Call us for more details: 02037010384

